

FX BUCKET ELEVATOR

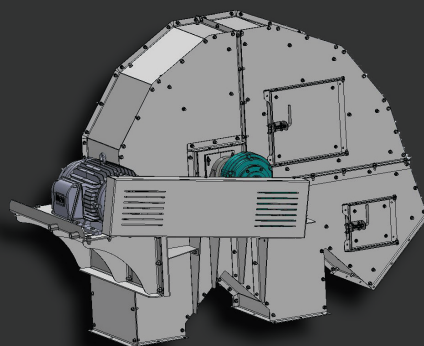

HEAD SECTIONS

Heads are designed with clean centrifugal discharge including:

- Heavy duty Crown faced double disc drum pulley with vulcanized rubber or replaceable slide lagging
- Medium duty pillow block bearings
- Inspection doors with hinges and clamps, weather tight
- Engineered and machined steel shafts
- Adjustable discharge baffle plate
- Split hood with shaft seals for ease on maintenance

DRIVES

- Standard class 2 Shaft Mount Reducer with belt drives
- OSHA Guard

BELT & BUCKETS

- Heavy duty supreme oil resistant (S.O.R.) rubber belt engineered to suit the correct requirements for the application.
- All buckets based on the application and customer preference.
- All hardware options are available per customer specifications

STANDARD FINISH OPTIONS (on all components)

- Galvanized



Model	CAPACITY RANGE (BPH)	DENSITY (LBS/BUS)	(MT/HR)
FX1210	36-3000	60	1-80
FX2416	3000-6000	60	80-163
FX3018	6000-11000	60	163-300

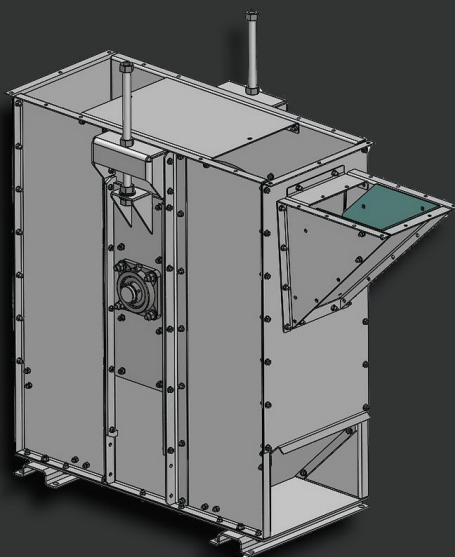

BOOT SECTION

- Heavy duty Crown faced double disc drum pulley
- Bolted construction
- Flange bearing
- Heavy duty threaded rod for screw take up belt tensioning
- Inspection doors with hinges and clamps, weather tight
- Inspection doors with heavy duty hinges and clamps, weather tight
- One standard inlet
- Heavy duty drum or wing style pulley

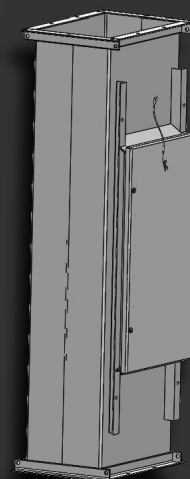

LEG TRUNKING

- Fully seal welded on a laser aligned jig to ensure strength and resistance to weather conditions
- Standard Heavy duty construction
- Standard 10' -0" trunking sections
- Structural angle iron end flanges, Horizontal tie angles and cross bracing
- Heavy duty inspection trunking with large service and maintenance doors front and back



STANDARD MAINTENANCE ACCESS OPTIONS

- Ladders and safety cages
- Head Service platforms
- Distributor platforms
- Step off and rest platforms

Safety and Monitoring sensors are available to suit your specifications and application

